

The Historic/Archaeological Probability Maps are the official County source designating historic or archaeological resources.

LAST REVISION: ZONING _____ OTHER _____

492728

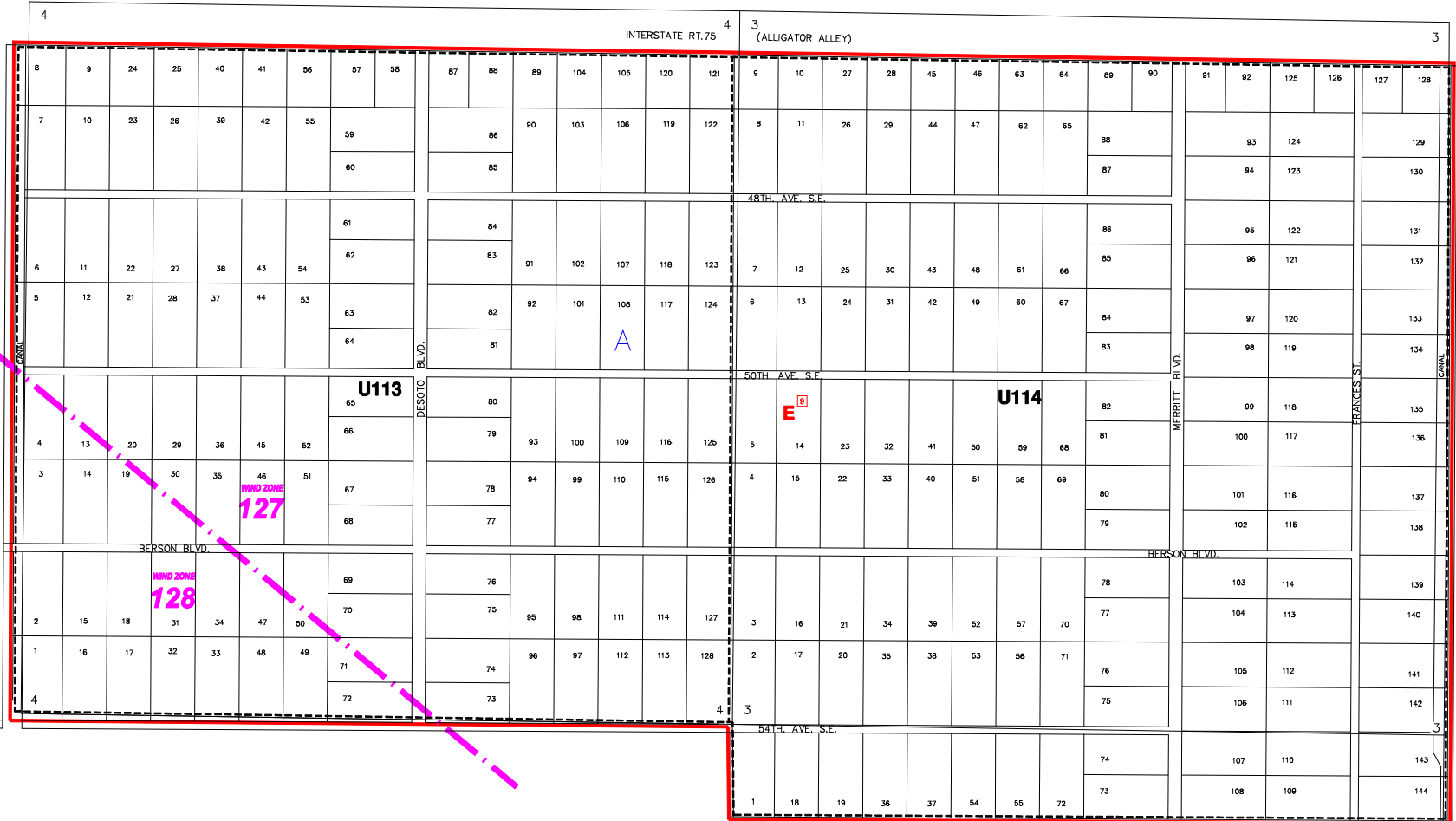

502526
GGE12A

5029

502728

GGE12D

113
114

— — — — — INDICATES WIND ZONE BOUNDARY LINE

| GOLDEN GATE ESTATES UNIT INDEX | | | SUBDIVISION INDEX | | |
|--------------------------------|------|-----|-------------------|------|----------|
| UNIT NO. | P.B. | Pg. | NO. | NAME | P.B. Pg. |
| U113 | 5 | 35 | | | |
| U114 | 5 | 36 | | | |

ZONING NOTES

ZONING OVERLAY NOTES
OVERLAYS CREATED BY
LDC ORD. No. 04-08 1-7-04
[E] NRPA

THIS IS TO CERTIFY THAT THIS IS A PAGE OF THE OFFICIAL ZONING ATLAS REFERRED TO AND ADOPTED BY REFERENCE BY ORDINANCE NO. 04-41 OF THE COUNTY OF COLLIER, FLORIDA, ADOPTED JUNE 22, 2004.

BY _____ CHAIRMAN
ATTEST _____ CLERK

FLOOD INSURANCE RATE MAP INFORMATION

COMMUNITY NUMBER: 120067 PANEL NUMBER: 450G,475G
PROGRAM: REGULAR EFFECTIVE DATE: NOV. 17, 2005
FLOOD ZONE: ALL A OR AS SHOWN ON MAP.
WIND ZONE: ALL _____ OR AS SHOWN ON MAP.

COLLIER COUNTY, FLORIDA

COMMUNITY DEVELOPMENT DIVISION

TWP 50S RNG 28E

SCALE 0 800

MAP NUMBER:
GGE12B