

MB7E

MB8D

MB8F

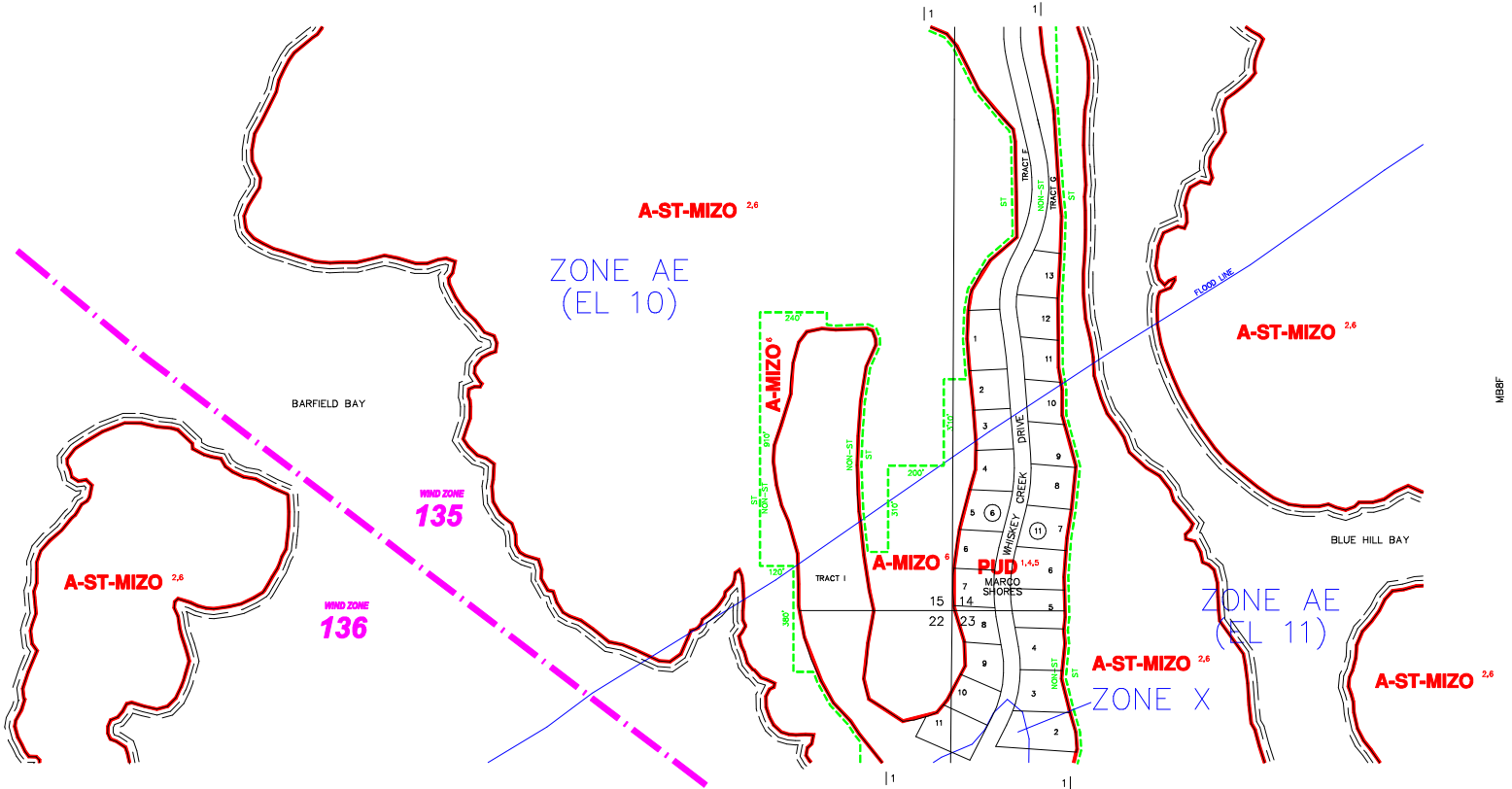

MB9E

----- INDICATES SPECIAL TREATMENT OVERLAY  
 - - - - - INDICATES WIND ZONE BOUNDARY LINE

**ZONING NOTES**  
 1 6/17/84 R-84-70 84-42  
 2 NEW MAP ON 3-16-88 FROM MARCO  
 3 SURVEY PUD PER MARCO CO ATTY, OF.  
 4 8-1-87 MIZO 97-28  
 5 7-88

THIS IS TO CERTIFY THAT THIS IS A PAGE OF THE OFFICIAL ZONING ATLAS REFERRED TO AND ADOPTED BY REFERENCE BY ORDINANCE NO. 91-102 OF THE COUNTY OF COLLIER, FLORIDA, ADOPTED OCTOBER 30, 1991.

| FLOOD INSURANCE RATE MAP INFORMATION      |                                |
|---|--------------------------------|
| COMMUNITY NUMBER:120067                   | PANEL NUMBER 825 E             |
| PROGRAM: REGULAR                          | EFFECTIVE DATE: AUGUST 3, 1992 |
| FLOOD ZONE: ALL _____ OR AS SHOWN ON MAP. |                                |
| WIND ZONE: ALL _____ OR AS SHOWN ON MAP.  |                                |

| SUBDIVISION INDEX |                                |      |      |     |      |      |     |
|-------------------|--------------------------------|------|------|-----|------|------|-----|
| NO.               | NAME                           | P.B. | Pg.  | NO. | NAME | P.B. | Pg. |
| 1                 | HORR'S ISLAND A.K.A. KEY MARCO | 21   | 5-19 | 11  |      |      |     |
| 2                 |                                |      |      | 12  |      |      |     |
| 3                 |                                |      |      | 13  |      |      |     |
| 4                 |                                |      |      | 14  |      |      |     |
| 5                 |                                |      |      | 15  |      |      |     |
| 6                 |                                |      |      | 16  |      |      |     |
| 7                 |                                |      |      | 17  |      |      |     |
| 8                 |                                |      |      | 18  |      |      |     |
| 9                 |                                |      |      | 19  |      |      |     |
| 10                |                                |      |      | 20  |      |      |     |

BY \_\_\_\_\_ CHAIRMAN  
 ATTEST \_\_\_\_\_ CLERK

COLLIER COUNTY, FLORIDA  
 COMMUNITY DEVELOPMENT DIVISION  
 TWP 52S RNG 26E SEC(S) 14,15,22,23  
 SCALE 0 400  
 MAP NUMBER: MB8E